



155 NUTFIELD ROAD, MERSTHAM, SURREY, RH1 3HH

**£400,000
FREEHOLD**

***** TERRACED, THREE BEDROOM HOUSE IN A POPULAR LOCATION,
WITH A GARAGE EN-BLOCK *****

Located in South Merstham, close to shops, schools and lots of green spaces, this late 1960's built house would make a great family home.

Through the front door you have an entrance porch with built in storage. There is a spacious living room, with a double glazed window to the front and stairs to the first floor. Through the double doors there is a kitchen and dining area, which both overlook and have doors out to the rear garden. Upstairs you have a landing with loft access, two generous double bedrooms, a further bedroom and a bathroom.

Outside there is a garden area to the front, and to the rear is an enclosed garden, with both lawn and patio areas. You have parking on the street within designated bays.

Nearby there is a parade of local shops, bus routes connecting you to Merstham and Redhill train stations, where you can hop on direct services to central London and Gatwick airport. Merstham also has a number of great schools, including Lime Tree and Merstham Park.

Mercers park is close by and offers a range of watersport as well as fishing. In addition, The Inn on Pond pub, which is in a lovely setting next to a cricket ground, can be found only half a mile away.

- | | |
|-----------------------|------------------|
| ■ VILLAGE LOCATION | ■ THREE BEDROOMS |
| ■ LOUNGE | ■ DINING ROOM |
| ■ KITCHEN | ■ BATHROOM |
| ■ GARAGE EN BLOCK | ■ SHOPS NEARBY |
| ■ COUNCIL TAX BAND: D | ■ EPC RATING: C |





ROOM DIMENSIONS:

ENTRANCE HALL

6'3 x 3'7 (1.91m x 1.09m)

LOUNGE

17'6 x 15'8(max) (5.33m x 4.78m(max))

DINING ROOM

10'8 x 9'7 (3.25m x 2.92m)

KITCHEN

10'5 x 5'10 (3.18m x 1.78m)

FIRST FLOOR

LANDING

BEDROOM ONE

15'5 x 9'7 (4.70m x 2.92m)

BEDROOM TWO

11'1 x 9'6 (3.38m x 2.90m)

BEDROOM THREE

11'1 x 5'10 (3.38m x 1.78m)

BATHROOM

7'10 x 5'9 (2.39m x 1.75m)

GAS CENTRAL HEATING

DOUBLE GLAZED WINDOWS

REAR GARDEN

EN BLOCK GARAGE



GROUND FLOOR
445 sq.ft. (41.4 sq.m.) approx.

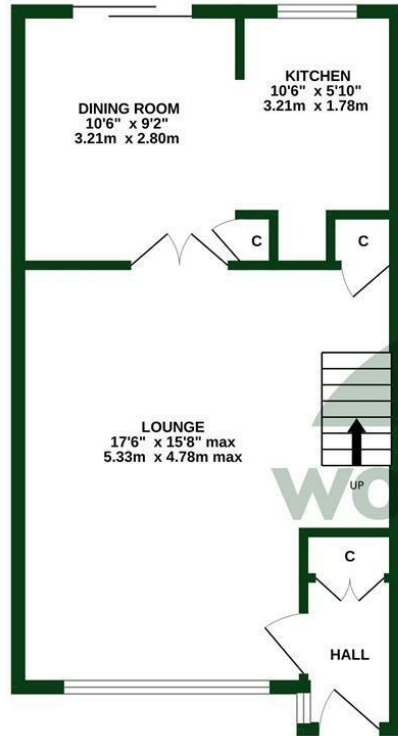

1ST FLOOR
439 sq.ft. (40.7 sq.m.) approx.

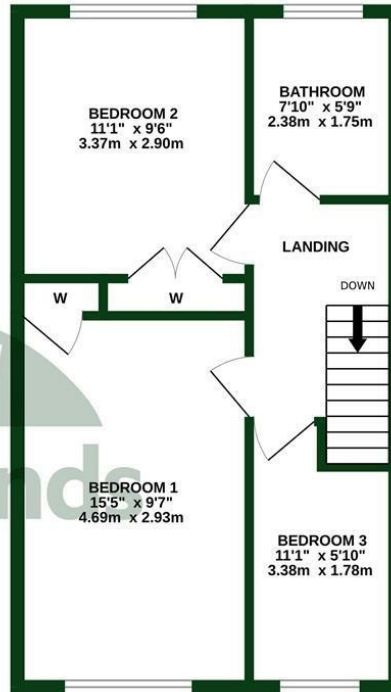

TOTAL FLOOR AREA: 884 sq ft (82.1 sq m) approx.

Whilst every attempt has been made to ensure the accuracy of the floorplan contained here, measurements of doors, windows, rooms and any other items are approximate and no responsibility is taken for any error, omission or mis-statement. This plan is for illustrative purposes only and should be used as such by any prospective purchaser. The services, systems and appliances shown have not been tested and no guarantee as to their operability or efficiency can be given.
Made with Metropix ©2025

woodlands

 OnTheMarket.com

 rightmove

 Zoopla

 The Property Ombudsman

 tsi
APPROVED CODE
TRADINGSTANDARDS.GOV.UK

 naea
propertymark
PROTECTED

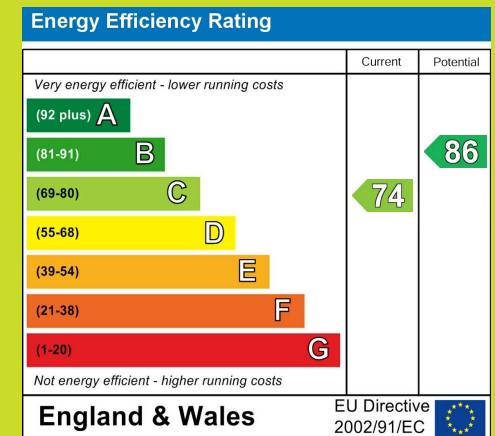

To view this property please call 01737 771777

www.woodlands-estates.co.uk

These particulars are set out as a general outline for the guidance of intending purchasers or lessees and do not constitute any part of an offer or contract. No person in the employment of the above named agents has any authority to make or give any representation or warranty whatsoever in relation to this property. If there is any point which is of particular interest, please contact our office and we will be pleased to check the information. The mention of any appliances and/or services does not imply they are in full and efficient working order.